

# PREPARING FOR YOUR VISIT TO NATIONAL MARITIME MUSEUM CORNWALL



**WELCOME!**

National Maritime Museum Cornwall is a museum about the sea and Cornwall.

# GETTING HERE

You can arrive by car, bus, train, boat or ferry.  
The car park is a short walk from the Museum.



This is the car park.



This is the walk to the Museum from  
the car park.

# ENTRANCE



When you arrive you will go through two glass sliding doors that opens automatically.



# FRONT DESK

This is where you get your tickets.



There is a ticket desk; if it is busy you may need to wait. Sometimes, the queue can go right out of the door.

It can be noisy in the Museum, if you would like ear defenders you can collect them here.

The Gift Shop is located next to the entrance. Usually people visit the Gift Shop at the end of their visit.

# TOILETS

There are accessible toilets located on the first and second floors which can be accessed via the lift or stairs and ramps. There are also toilets in the Learning Centre on Level 2 and in the Library on the ground floor.





# BOAT HALL

The first room you will see is very big. There are lots of boats, some hanging from the ceiling. They will not fall down.



There are screens which can help you learn more about the boats.

# WHAT YOU MIGHT SEE...

RNLI rescue zone and life rafts



Objects in cases



Touch screens



Change boxes where you can put a coin in and watch it fall down.



Paintings





# BOAT POOL

You can sail models of boats in this pool. You can adjust the sails and steer them through the water, they do not have motors.

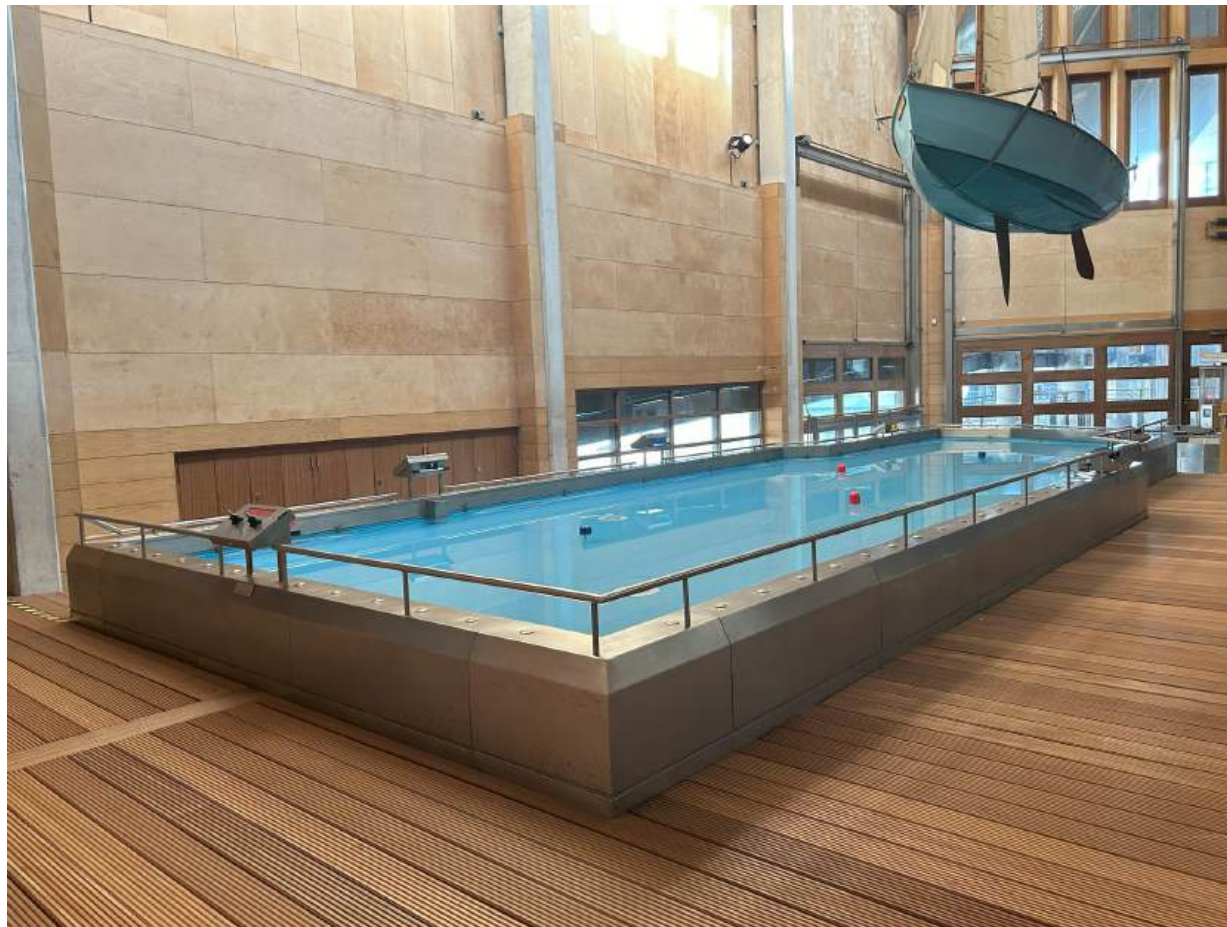

You may have to queue for a go on the Boat Pool.



# SURF! EXHIBITION

There are lots of screens and some sound in the exhibition.

There is a board where you can practice making a surf board. There is also a wall where you can decorate your own board.

There is a ramp and a walkway for the next level. Follow the lights on the ramp.

You will see a big sculpture of a wave above your head; you can go under, it will not fall down.



# SURF! EXHIBITION



There is a film at the end. You can stop and watch, or simply walk past.

There is a surf board on the floor at the exit. You can stand on it. It is great fun!



# **We hope you enjoy your visit!**

You can climb inside a life raft, lifeboat and jet ski.

There are some challenging pictures in the Cornwall Gallery.

There are stuffed animals (taxidermy not soft toys) in the Curiosity Shop in the Falmouth Packet Ships Gallery.

There is a café.

There is a play area with climbing frames – this is suitable for children aged 2 to 7.

You might like some areas more than others—that's ok!

